

DOORS & WINDOWS SCHEDULE

NO.	DOOR / WINDOW	SIZE	QTY	REMARKS
01	DOOR	1000x2100	100	
02	DOOR	1000x2100	100	
03	DOOR	1000x2100	100	
04	DOOR	1000x2100	100	
05	DOOR	1000x2100	100	
06	DOOR	1000x2100	100	
07	DOOR	1000x2100	100	
08	DOOR	1000x2100	100	
09	DOOR	1000x2100	100	
10	DOOR	1000x2100	100	
11	DOOR	1000x2100	100	
12	DOOR	1000x2100	100	
13	DOOR	1000x2100	100	
14	DOOR	1000x2100	100	
15	DOOR	1000x2100	100	
16	DOOR	1000x2100	100	
17	DOOR	1000x2100	100	
18	DOOR	1000x2100	100	
19	DOOR	1000x2100	100	
20	DOOR	1000x2100	100	
21	DOOR	1000x2100	100	
22	DOOR	1000x2100	100	
23	DOOR	1000x2100	100	
24	DOOR	1000x2100	100	
25	DOOR	1000x2100	100	
26	DOOR	1000x2100	100	
27	DOOR	1000x2100	100	
28	DOOR	1000x2100	100	
29	DOOR	1000x2100	100	
30	DOOR	1000x2100	100	
31	DOOR	1000x2100	100	
32	DOOR	1000x2100	100	
33	DOOR	1000x2100	100	
34	DOOR	1000x2100	100	
35	DOOR	1000x2100	100	
36	DOOR	1000x2100	100	
37	DOOR	1000x2100	100	
38	DOOR	1000x2100	100	
39	DOOR	1000x2100	100	
40	DOOR	1000x2100	100	
41	DOOR	1000x2100	100	
42	DOOR	1000x2100	100	
43	DOOR	1000x2100	100	
44	DOOR	1000x2100	100	
45	DOOR	1000x2100	100	
46	DOOR	1000x2100	100	
47	DOOR	1000x2100	100	
48	DOOR	1000x2100	100	
49	DOOR	1000x2100	100	
50	DOOR	1000x2100	100	
51	DOOR	1000x2100	100	
52	DOOR	1000x2100	100	
53	DOOR	1000x2100	100	
54	DOOR	1000x2100	100	
55	DOOR	1000x2100	100	
56	DOOR	1000x2100	100	
57	DOOR	1000x2100	100	
58	DOOR	1000x2100	100	
59	DOOR	1000x2100	100	
60	DOOR	1000x2100	100	
61	DOOR	1000x2100	100	
62	DOOR	1000x2100	100	
63	DOOR	1000x2100	100	
64	DOOR	1000x2100	100	
65	DOOR	1000x2100	100	
66	DOOR	1000x2100	100	
67	DOOR	1000x2100	100	
68	DOOR	1000x2100	100	
69	DOOR	1000x2100	100	
70	DOOR	1000x2100	100	
71	DOOR	1000x2100	100	
72	DOOR	1000x2100	100	
73	DOOR	1000x2100	100	
74	DOOR	1000x2100	100	
75	DOOR	1000x2100	100	
76	DOOR	1000x2100	100	
77	DOOR	1000x2100	100	
78	DOOR	1000x2100	100	
79	DOOR	1000x2100	100	
80	DOOR	1000x2100	100	
81	DOOR	1000x2100	100	
82	DOOR	1000x2100	100	
83	DOOR	1000x2100	100	
84	DOOR	1000x2100	100	
85	DOOR	1000x2100	100	
86	DOOR	1000x2100	100	
87	DOOR	1000x2100	100	
88	DOOR	1000x2100	100	
89	DOOR	1000x2100	100	
90	DOOR	1000x2100	100	
91	DOOR	1000x2100	100	
92	DOOR	1000x2100	100	
93	DOOR	1000x2100	100	
94	DOOR	1000x2100	100	
95	DOOR	1000x2100	100	
96	DOOR	1000x2100	100	
97	DOOR	1000x2100	100	
98	DOOR	1000x2100	100	
99	DOOR	1000x2100	100	
100	DOOR	1000x2100	100	

SPECIFICATION OF BUILDINGS

R.C.C. FRAME STRUCTURE WITH CONC. GRADE 53.53.
 100 M.M. THICK EXTERIOR WALLS & 75 M.M. THICK INTERNAL WALLS
 STEEL 2 - SECTION WINDOWS
 15 & 14 CM DIA. PIPES FOR INTERNAL WALLS AND CEILING
 RESPECTIVELY.
 P.O.P. FINISH ON INTERNAL WALLS & CEILING
 P.O.P. FINISH ON INTERNAL WALLS & CEILING

CERTIFICATE OF GEO-TECHNICAL ENGINEER
 UNDERSIGNED HAS INSPECTED THE SITE AND CARRIED OUT
 SOIL INVESTIGATION HEREON. IT IS CERTIFIED THAT THE
 EXISTING SOIL OF THE SITE IS ABLE TO CARRY THE LOAD
 OF THE PROPOSED CONSTRUCTION AND THE
 FOUNDATION SYSTEM PROPOSED IS FEASIBLE
 IN ALL RESPECT FROM GEO-TECHNICAL POINT OF VIEW.

SIGNATURE OF OWNER
 Director of Marine Change Projects
 Constant Agency for M/s Marine Project Limited & 7 Others
 22, Prince Avenue Ship Road, Kolkata - 700057

SIGNATURE OF STRUCTURAL ENGINEER
 CHANDU PRASAD KHANNA
 BE (CIVIL), M.E. (STRUCTURAL), M.T.E. (INDIA)
 63-22, BHIBHANGI WALKER LANE, HOWRAH - 711011.

SIGNATURE OF ARCHITECT
 SANJIB GUHA
 BE (CIVIL), M.E. (ARCHITECTURE), M.T.E. (INDIA)
 14, RAJCHANDRA DATTA ROAD,
 KOLKATA-70

SIGNATURE OF STRUCTURAL REVIEWER
 SANJIB GUHA
 BE (CIVIL), M.E. (ARCHITECTURE), M.T.E. (INDIA)
 14, RAJCHANDRA DATTA ROAD,
 KOLKATA-70

CERTIFICATE OF OWNER
 1. I, UNDERSIGNED, DIRECTOR OF MARINE CHANGE PROJECTS, HAVE
 DURING CONSTRUCTION OF THE BUILDING.
 2. I, M.A.C. AUTHORITY WILL NOT BE RESPONSIBLE FOR
 THE CONSTRUCTION OF THE BUILDING.
 3. IF ANY SHARED DOCUMENTS FOUND TO BE SIGNED BY
 A.M.C. AUTHORITY MAY REVOKE THE SANCTION PLAN.
 4. THE CONSTRUCTION OF WATER RESERVOIR AND SEPTIC TANK
 DECIDED UNDER THE GUIDANCE OF ARCHITECT & E.S.E.

SIGNATURE OF ARCHITECT
 THE I.B.A. HAS CERTIFIED ON THE PLAN (ITSELF WITH
 FULL RESPONSIBILITY THAT THE BUILDING PLAN HAS
 BEEN DRAWN UP AS PER PROVISION OF M.C.C. BLDG
 RULES 2008, AS AMENDED FROM TIME TO TIME AND
 THE EXISTING ROAD CONFORM WITH THE PLAN AND IT
 IS A BUILDABLE SITE AND NOT A TANK OR A FILLED
 UP TANK.

SIGNATURE OF ARCHITECT
 Rajanagar Anand
 Anand
 Member of Council of
 Architects
 Registration No. CA/17/17910
 Address: 88, RING STREET (2ND FLOOR),
 KOLKATA-700016

SIGNATURE OF ARCHITECT
 RAJ KUMAR AGARWAL
 Council Registration No. CA/17/77940
 Address: 88, RING STREET (2ND FLOOR),
 KOLKATA-700016

TYPICAL FLOOR PLAN
 PROJECT
 ADDITION OF ONE FLOOR ABOVE B-6-G-11 (86.9 M HT)
 STORED RESIDENTIAL BUILDING AT PRE. NO - 112
 (PREVIOUSLY KNOWN AS 24) BASANTNALLA SHAH ROAD, IN
 WARD NO - 17, BOROUGH NO - XII, KOLKATA-700053 U/S
 OF AME BLDG. RULE 2009 SANCTIONED VIDE BP
 NO - 2018/0258 DATED-08-12-18

TYPICAL FLOOR PLAN
 (3RD TO 11TH FLOOR PLAN)

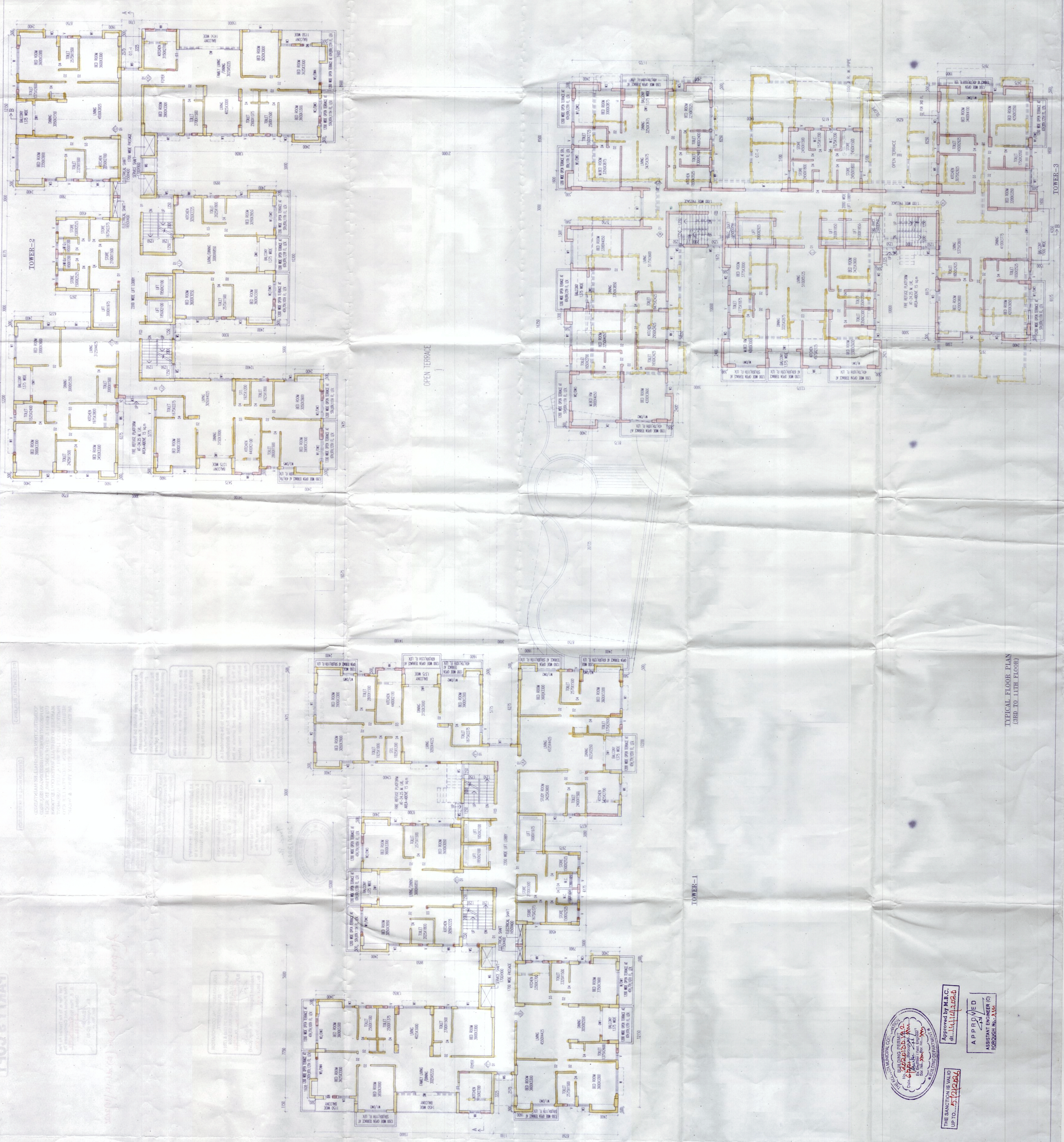

APPROVED
 ASSISTANT ENGINEER (C)
 BOROUGH NO. - XII

APPROVED BY M.B.C.
 dt. 14/11/2020

THE SANCTION IS VALID UP TO...

APPROVED
 ASSISTANT ENGINEER (C)
 BOROUGH NO. - XII